



TimePilot Quick Start Guide

1. Unpack it.



Time Clock Station



USB Adaptor



Software CD



Communications Cable



USB Cable



Power Supply



iButtons



Instruction Manual

2. Assemble it.

1 Run your yellow Communications Cable from the PC to where the TimePilot Station will be mounted. Then plug the cable into the USB Adaptor and the Station.

2 Plug your USB cable and power supply into the USB Adaptor.



Stop! Don't plug the USB cable into your PC yet!

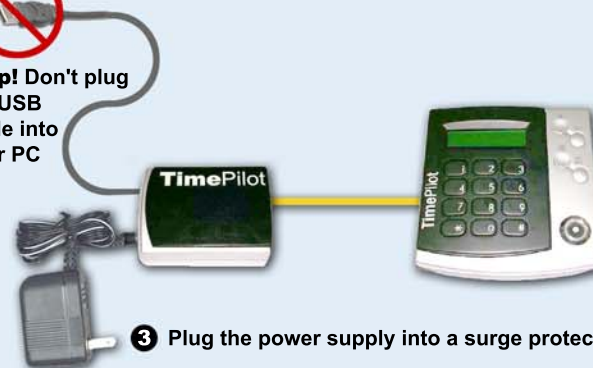

3 Plug the power supply into a surge protector.

3. Mount your clock.

See the Instruction Manual for tips on mounting your clock to a wall.

4. Install your software.

Place the CD into your CD drive and follow the on-screen instructions.

5. Set up your company.

Set your pay policies, enter your employees and assign iButtons using the Configuration Wizard in Configuration Manager.



6. Connect the PC.

Plug the USB cable into a USB port on your computer and follow the on-screen instructions.

7. Start the clock.

Click the TimePilot icon on your desktop to open Program Manager, then click the "Hardware Manager" button. Hardware Manager must be running for the clock to function.

Please see the Instruction Manual for details and much more about the TimePilot system, or call Technical Support at 1-630-389-3303.